

**SPINE**



## CERVICAL INTERVERTEBRAL PEEK CAGE

### Anatomic Design

- Toothed surface with titanium pinsSecures stable and strong fixation, prevents migration of the implant.
- Titanium pins let us identify the actual cage position.
- Large grafting area ensures optimum fusion

### PRODUCT DESCRIPTION

CERVICAL PEEK CAGE 4x12 MM

CERVICAL PEEK CAGE 5x12 MM

CERVICAL PEEK CAGE 6x12 MM

CERVICAL PEEK CAGE 7x12 MM

CERVICAL PEEK CAGE 8x12 MM

CERVICAL PEEK CAGE 9x12 MM

CERVICAL PEEK CAGE 4x14 MM

CERVICAL PEEK CAGE 5x14 MM

CERVICAL PEEK CAGE 6x14 MM

CERVICAL PEEK CAGE 7x14 MM

CERVICAL PEEK CAGE 8x14 MM

CERVICAL PEEK CAGE 9x14 MM



## CERVICAL INTERVERTEBRAL EXPANDABLE PEEK CAGE

### Suitable Design

- Perfectly fits the disc space and patient's anatomy Supports foramens release and ensures long term, safe, strong implantation.
- Titanium expanding mechanism
- Color coded Titanium expanding mechanism together with titanium pins allow us to evaluate the actual cage position under Xray
- Large grafting area ensures optimum fusion

### PRODUCT DESCRIPTION

CERVICAL EXPANDABLE PEEK CAGE 4X12 MM

CERVICAL EXPANDABLE PEEK CAGE 4X14 MM

CERVICAL EXPANDABLE PEEK CAGE 5X12 MM

CERVICAL EXPANDABLE PEEK CAGE 5X14 MM

CERVICAL EXPANDABLE PEEK CAGE 6X12 MM

CERVICAL EXPANDABLE PEEK CAGE 6X14 MM

CERVICAL EXPANDABLE PEEK CAGE 7X12 MM

CERVICAL EXPANDABLE PEEK CAGE 7X14 MM

CERVICAL EXPANDABLE PEEK CAGE 8X12 MM

CERVICAL EXPANDABLE PEEK CAGE 8X14 MM

CERVICAL EXPANDABLE PEEK CAGE 9X12 MM

CERVICAL EXPANDABLE PEEK CAGE 9X14 MM

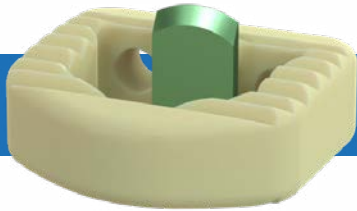

## CERVICAL INTERVERTEBRAL BLADED PEEK CAGE

### Anatomic Design With Blades

- Ti6Al4V Eli alloy blades ensures solid fixation of the cage to vertabras and prevent the migration.
- Color coding of blades for the distinction of the different sizes.
- Large grafting area ensures optimum fusion

### PRODUCT DESCRIPTION

CERVICAL BLADED PEEK CAGE 4x13 MM  
 CERVICAL BLADED PEEK CAGE 5x13 MM  
 CERVICAL BLADED PEEK CAGE 6x13 MM  
 CERVICAL BLADED PEEK CAGE 7x13 MM  
 CERVICAL BLADED PEEK CAGE 8x13 MM  
 CERVICAL BLADED PEEK CAGE 9x13 MM  
 CERVICAL BLADED PEEK CAGE 4x14 MM  
 CERVICAL BLADED PEEK CAGE 5x14 MM  
 CERVICAL BLADED PEEK CAGE 6x14 MM  
 CERVICAL BLADED PEEK CAGE 7x14 MM  
 CERVICAL BLADED PEEK CAGE 8x14 MM  
 CERVICAL BLADED PEEK CAGE 9x14 MM

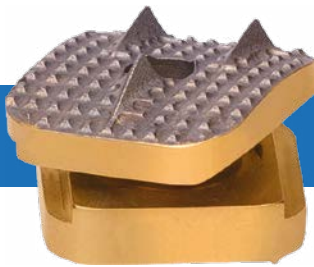

## CERVICAL DISK PROSTHESIS

### Anatomic Design

- Improves adherence to end plates of vertabrae, prevents migration of the implant. Ensures long term implantation.
- Herringbone pattern surface  
 Perfectly fits in the body  
 Controlled movements in all planes and axes

### PRODUCT DESCRIPTION

CERVICAL DISC PROSTHESIS 12 X12X 04 MM  
 CERVICAL DISC PROSTHESIS 12 X12X 05 MM  
 CERVICAL DISC PROSTHESIS 12 X12X 06 MM  
 CERVICAL DISC PROSTHESIS 12 X12X 07 MM  
 CERVICAL DISC PROSTHESIS 12 X12X 08 MM  
 CERVICAL DISC PROSTHESIS 12 X12X 09 MM  
 CERVICAL DISC PROSTHESIS 13 X13X 04 MM  
 CERVICAL DISC PROSTHESIS 13 X13X 05 MM  
 CERVICAL DISC PROSTHESIS 13 X13X 06 MM  
 CERVICAL DISC PROSTHESIS 13 X13X 07 MM  
 CERVICAL DISC PROSTHESIS 13 X13X 08 MM  
 CERVICAL DISC PROSTHESIS 13 X13X 09 MM  
 CERVICAL DISC PROSTHESIS 14 X14X 04 MM  
 CERVICAL DISC PROSTHESIS 14 X14X 05 MM  
 CERVICAL DISC PROSTHESIS 14 X14X 06 MM  
 CERVICAL DISC PROSTHESIS 14 X14X 07 MM  
 CERVICAL DISC PROSTHESIS 14 X14X 08 MM  
 CERVICAL DISC PROSTHESIS 14 X14X 09 MM

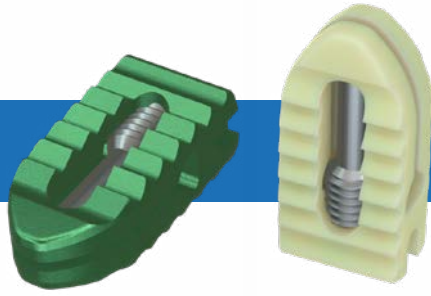

## LUMBAR PLIF E/D CAGE

### Suitable Design

- Perfectly fits the disc space and patient's anatomy. Supports foraminae release and ensures long term, safe, strong implantation.
- It is available in PEEK and Ti6Al4V alloy.
- Titanium expanding mechanism for PEEK Plif E/D Cage.
- Color coded Titanium expanding mechanism together with titanium pins allow us to evaluate the actual cage position under X-ray.

### PRODUCT DESCRIPTION

|                                        |
|----------------------------------------|
| LUMBAR PLIF E/D CAGE, Ti 0 X 10 X 7    |
| LUMBAR PLIF E/D CAGE, Ti 0 X 10 X 8    |
| LUMBAR PLIF E/D CAGE, Ti 0 X 10 X 9    |
| LUMBAR PLIF E/D CAGE, Ti 0 X 10 X 10   |
| LUMBAR PLIF E/D CAGE, Ti 0 X 10 X 11   |
| LUMBAR PLIF E/D CAGE, Ti 0 X 10 X 12   |
| LUMBAR PLIF E/D CAGE, Ti 0 X 10 X 13   |
| LUMBAR PLIF E/D CAGE, Ti 0 X 10 X 14   |
| LUMBAR PLIF E/D CAGE, Ti 0 X 10 X 15   |
| LUMBAR PLIF E/D CAGE, PEEK 0 X 10 X 7  |
| LUMBAR PLIF E/D CAGE, PEEK 0 X 10 X 8  |
| LUMBAR PLIF E/D CAGE, PEEK 0 X 10 X 9  |
| LUMBAR PLIF E/D CAGE, PEEK 0 X 10 X 10 |
| LUMBAR PLIF E/D CAGE, PEEK 0 X 10 X 11 |
| LUMBAR PLIF E/D CAGE, PEEK 0 X 10 X 12 |
| LUMBAR PLIF E/D CAGE, PEEK 0 X 10 X 13 |
| LUMBAR PLIF E/D CAGE, PEEK 0 X 10 X 14 |
| LUMBAR PLIF E/D CAGE, PEEK 0 X 10 X 15 |

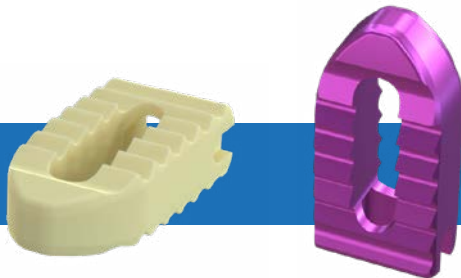

## LUMBAR PLIF CAGE

### Anatomic Design

- A rigid bullet shape Plif cage.
- It is available in PEEK and Ti6Al4V alloy.
- PEEK Plif Cage has Ti6Al4V alloy pins for X-ray, scopy visibility.
- Secures stable and strong fixation, prevents migration of the implant.
- Large grafting area ensures optimum fusion.

### PRODUCT DESCRIPTION

|                                    |
|------------------------------------|
| LUMBAR PLIF CAGE, Ti 0 X 10 X 7    |
| LUMBAR PLIF CAGE, Ti 0 X 10 X 8    |
| LUMBAR PLIF CAGE, Ti 0 X 10 X 9    |
| LUMBAR PLIF CAGE, Ti 0 X 10 X 10   |
| LUMBAR PLIF CAGE, Ti 0 X 10 X 11   |
| LUMBAR PLIF CAGE, Ti 0 X 10 X 12   |
| LUMBAR PLIF CAGE, Ti 0 X 10 X 13   |
| LUMBAR PLIF CAGE, Ti 0 X 10 X 14   |
| LUMBAR PLIF CAGE, Ti 0 X 10 X 15   |
| LUMBAR PLIF CAGE, PEEK 0 X 10 X 7  |
| LUMBAR PLIF CAGE, PEEK 0 X 10 X 8  |
| LUMBAR PLIF CAGE, PEEK 0 X 10 X 9  |
| LUMBAR PLIF CAGE, PEEK 0 X 10 X 10 |
| LUMBAR PLIF CAGE, PEEK 0 X 10 X 11 |
| LUMBAR PLIF CAGE, PEEK 0 X 10 X 12 |
| LUMBAR PLIF CAGE, PEEK 0 X 10 X 13 |
| LUMBAR PLIF CAGE, PEEK 0 X 10 X 14 |
| LUMBAR PLIF CAGE, PEEK 0 X 10 X 15 |

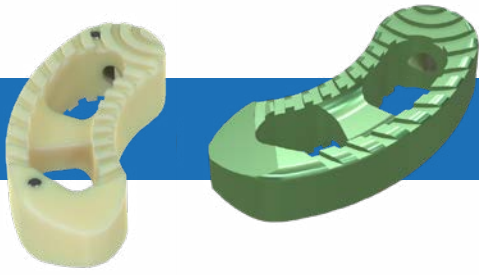

## LUMBAR TLIF CAGE

### Anatomic Design

- Banana shape Cage
- Available in PEEK and Ti6Al4V eli
- PEEK Tlif Cage has ti6Al4V eli pins for Xray, scopy visibility.

#### **PRODUCT DESCRIPTION**

|                                    |
|------------------------------------|
| LUMBAR TLIF CAGE, TI 30 X 0 X 7    |
| LUMBAR TLIF CAGE, TI 30 X 0 X 8    |
| LUMBAR TLIF CAGE, TI 30 X 0 X 9    |
| LUMBAR TLIF CAGE, TI 30 X 0 X 10   |
| LUMBAR TLIF CAGE, TI 30 X 0 X 11   |
| LUMBAR TLIF CAGE, TI 30 X 0 X 12   |
| LUMBAR TLIF CAGE, TI 30 X 0 X 13   |
| LUMBAR TLIF CAGE, TI 30 X 0 X 14   |
| LUMBAR TLIF CAGE, TI 30 X 0 X 15   |
| LUMBAR TLIF CAGE, TI 30 X 0 X 16   |
| LUMBAR TLIF CAGE, TI 30 X 0 X 17   |
| LUMBAR TLIF CAGE, TI 30 X 0 X 18   |
| LUMBAR TLIF CAGE, PEEK 30 X 0 X 7  |
| LUMBAR TLIF CAGE, PEEK 30 X 0 X 8  |
| LUMBAR TLIF CAGE, PEEK 30 X 0 X 9  |
| LUMBAR TLIF CAGE, PEEK 30 X 0 X 10 |
| LUMBAR TLIF CAGE, PEEK 30 X 0 X 11 |
| LUMBAR TLIF CAGE, PEEK 30 X 0 X 12 |
| LUMBAR TLIF CAGE, PEEK 30 X 0 X 13 |
| LUMBAR TLIF CAGE, PEEK 30 X 0 X 14 |
| LUMBAR TLIF CAGE, PEEK 30 X 0 X 15 |
| LUMBAR TLIF CAGE, PEEK 30 X 0 X 16 |
| LUMBAR TLIF CAGE, PEEK 30 X 0 X 17 |
| LUMBAR TLIF CAGE, PEEK 30 X 0 X 18 |





## POSTERIOR CERVICAL STABILIZATION SCREW SYSTEM



Posterior cervical screw system: Low profile screw, self tapping screws.

Rod Diameter: Ø3.5 mm

Rod Length: Between 40-250 mm

Screw Diameter: Ø3.5-4.0-4.5 mm

Screw Length: Between 10-40 mm

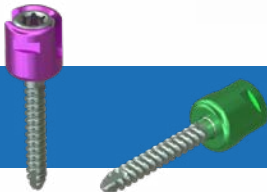

## POSTERIOR PEDIATRIC STABILIZATION SCREW SYSTEM

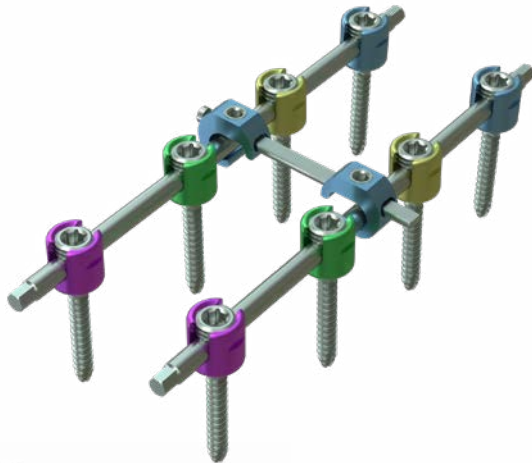

Pediatric posterior stabilization system; There are many kinds of screws and rods. Transfer connector, domino types, lateral connector, pedicle hook, laminar hook, many products are available in the system.

The screws: Reduction, Low profile, Self tapping.

Rod Diameter: Ø5.0 mm

Rod Length: Between 40-1000 mm

Screw Diameter: Ø3.5-4.0-4.5-5.0-5.5-6.0-6.5-7.0 mm

Screw Length: Between 20-120 mm



## POSTERIOR STABILIZATION SCREW SYSTEM



In the posterior stabilization system; There are many kinds of screws and rods. Transfer connector, peek rod, domino types, lateral connector, pedicle hook, laminar hook, many products are available in the system.

This system is suitable for use with posterior cervical screw system and pediatric screw system.

The screws: Cannulated, Reduction, Low profile, Self tapping.

Rod Diameter: Ø6.0 mm

Rod Length: Between 40-1000 mm

Screw Diameter: Ø4.5-5.0-5.5-6.0-6.5-7.2-8.0-9.0 mm

Screw Length: Between 25-120 mm

## CERVICAL ANTERIOR PLATE



### PLATE ANTERIOR

Made from titanium Ti6Al4V ELI raw material

Plates include anti-migration locking mechanism that cover the heads of the bone screws to reduce the potential for screw back-out.

The fixation construct consists of a cervical plate that is attached to the vertebral body of the cervical spine with self-tapping bone screws using an anterior approach.

Pre-bent plates require no or minimum contouring Bone screws are color coded according to diameter while plates supplied in a fixed color.

Wide range of sizes answers different kind of anatomical needs.

System is not suitable for posterior usage.

## CORPECTOMY EXPANDABLE CAGE



### D/E CORPECTOMY CAGE

Ti6Al4V eli cage with a self expanding mechanism and axial hole to allow grafting material.

Protrusions on the superior and inferior surfaces of each device grip the endplates of the adjacent vertebrae to resist expulsion.

Suitable to be used in cervical, thoracic and lumbar spine.

The device is intended to be used with supplemental fixation:

- Karspine Spinal Stabilisation System
- Karspine Anterior Cervical Plate System

## MESH CAGE



### MESH CAGE

- A round hollow Ti6Al4V eli cage. It may be trimmed for a custom fit.
- Comes in different diameters which makes it suitable for cervical, thoracic and lumbar spine.
- Can be inserted anteriorly, laterally or antero- laterally, depending on the spinal level involved.



İstanbul Trakya Free Zone Ferhatpaşa SB Mah.  
Gonca Sokak No:4-Z13 Çatalca-İstanbul / Türkiye  
Tel:+90 212 786 61 89 e-mail: info@inovamed.com.tr  
www.inovamed.com.tr